



## 5 Switches, control units, sockets and plugs



### 5 Sockets and plugs ATX

#### 7 32 A Built-in wall sockets

The built-in wall sockets are fitted with an integrated interruption of the poles by a double-safety device. When the plug is pulled, there will be:

- an automatic and simultaneous interruption of every phase in a first explosion-proof chamber
- voltage-free separation of the pins in a second explosion-proof chamber

The cover can be locked in 3 positions:

- with connected plug under tension
- with connected plug voltage free
- without plug, cover closed

For safety reasons, only the mentioned explosion-proof plugs fit in the sockets. The explosion-proof plugs do fit in normal sockets in accordance with CEE17.

II 2 G Ex d e IIC T6/T5

II 2 D Ex tD A21 IP66 T68°C

Zone 0	✗	Zone 20	✗
Zone 1	✓	Zone 21	✓
Zone 2	✓	Zone 22	✓

LCIE02ATEX6068



#### Specifications

Connection	2x6mm <sup>2</sup>
Protection	IP66 (with or without connected plug)
Material	high-quality, impact-resistant plastic
Ambiant temperature	-20°C - +50/55°C

#### Ordering data

Code	No. of poles	Nom. current	Voltage	Weight
I32-400-4	3P+E	32A	380/415 VAC	0,65 kg

#### Dimensional sketches

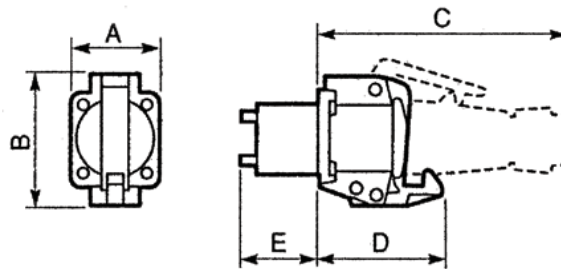

Product code	Dimensions				
	A	B	C	D	E
I32-400-4	74	103	210	110	60

